

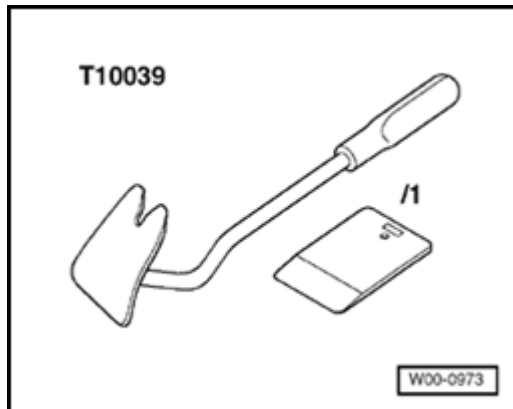

## Door trim

### Tools

Required special tools, workshop equipment, testing and measuring equipment, and aids



- Release lever T10039

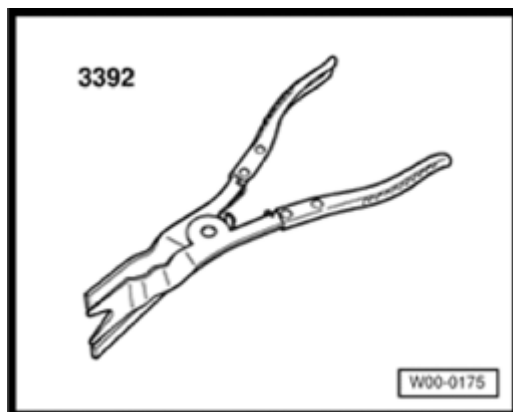

- Pliers 3392

### Driver side front door trim, removing and installing

#### Removing

- Switch off ignition.
- Using the Release lever T10039/1 pry out the panel upper edge molding - **1** - from the locking tabs, placing the release lever at the rear area of the panel.
- Disconnect the Bowden cable for the door lock actuator.

- Disconnect connector - **2** - .
- Remove bolts - **3** - and - **4** - behind the panel upper edge molding (3.5 Nm).

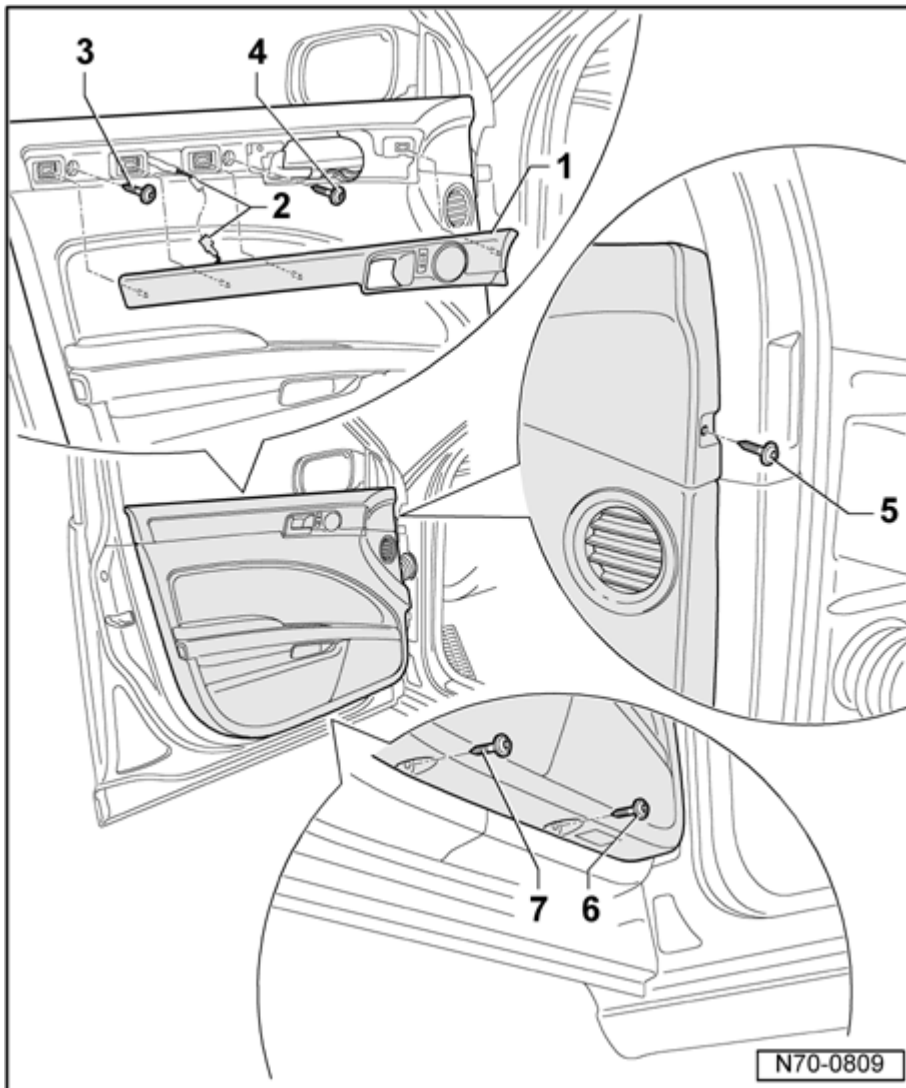

- Remove bolts - **5** - , - **6** - and - **7** - (3.5 Nm).
- Using a small screwdriver, remove the lamp and door pull handle - **1** - from the locking tab and disconnect the connector - **2** - .
- Remove the two bolts - **3** - (3.5 Nm).

**Note :**

- *The bolts - **2** - and - **3** - are secured with a sleeve and cannot be removed.*

- Remove the door trim panel from the

carrier, using the pliers 3392 in the area of the attaching points.

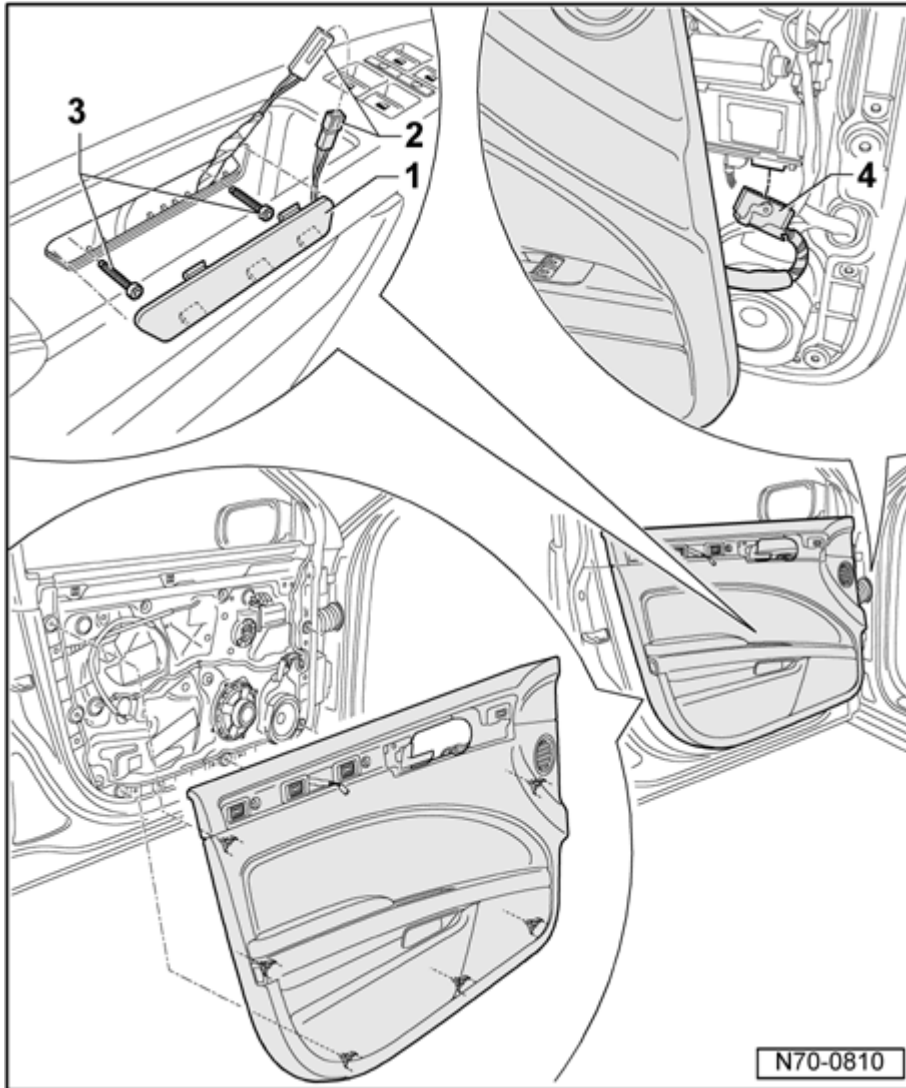

- Release the connector - **4** - and pull it out of the control module.

- Pull out the window frame trim - **1** - from the door seal weatherstrip and separate the speaker connector - **2** - .

- Remove the five bolts and remove the right support frame - **3** - (3.5 Nm).

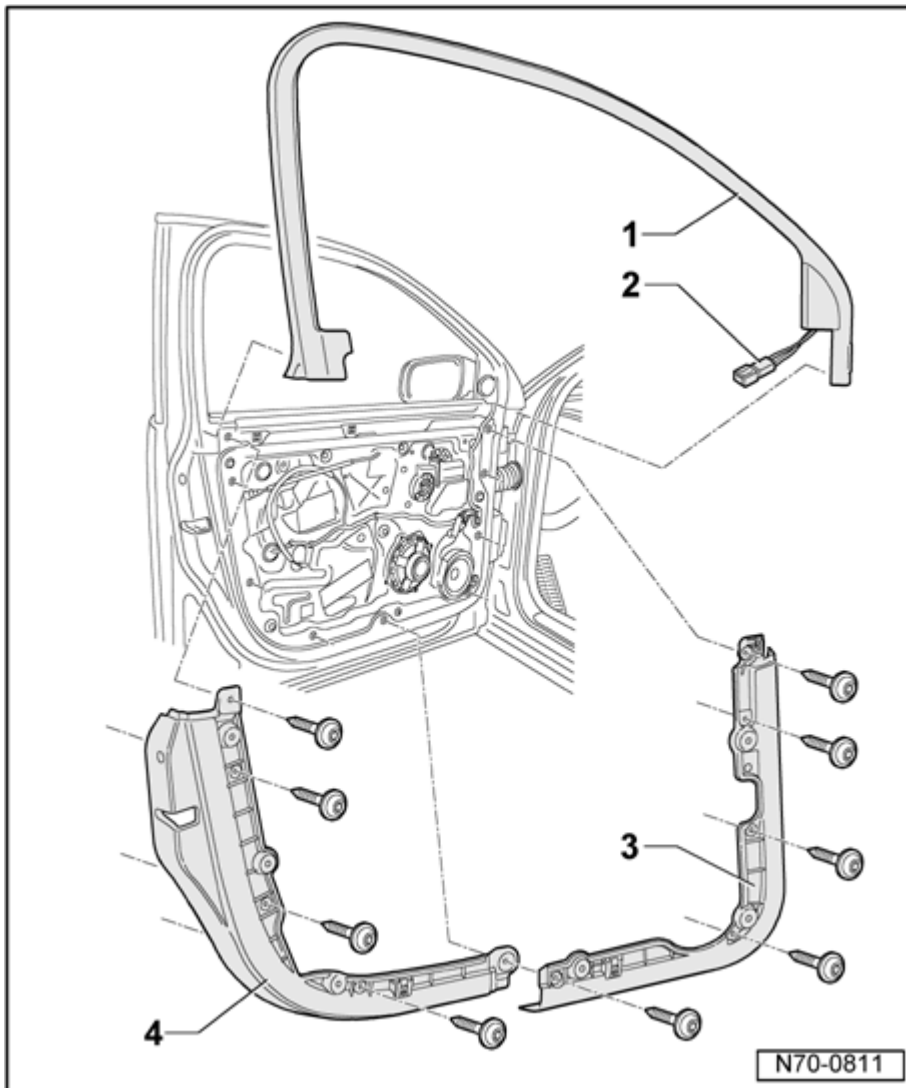

- Remove the four bolts and remove the left support frame - **4** - (3.5 Nm).

### Installing

- Installation is performed in the reverse order of removal.

### Installation notes:

- When the door trim, in the area of the retainers, is positioned in front of the corresponding openings in the door, push the door trim into the mountings.
- Then, fasten the bolts, which are secured against falling out via a sleeve.

### Passenger side front door trim, removing and installing

#### Removing

- Switch off ignition.
- Using the Release lever T10039/1 pry out the panel upper edge molding - **1** - from the locking tabs, placing the release lever at the rear area of the panel.
- Disconnect the Bowden cable for the door lock actuator.
- Disconnect connector - **2** - .
- Remove bolts - **3** - and - **4** - behind the panel upper edge molding (3.5 Nm).

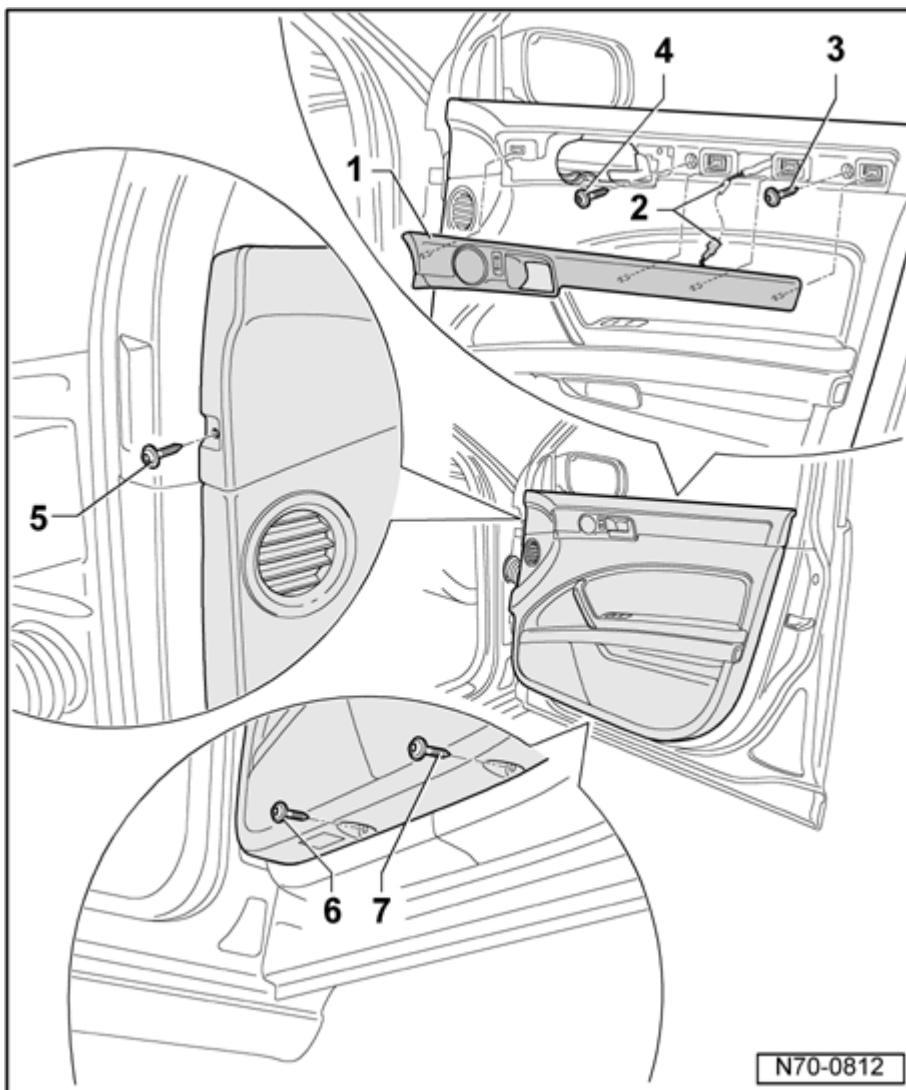

- Remove bolts - **5** - , - **6** - and - **7** - (3.5 Nm).
- Using a small screwdriver, remove the upper portion of the handle cover - **1** - from the locking tab.

- Remove bolts - **2** - and - **3** - (3.5 Nm).

**Note :**

- *The bolt - **2** - is secured with a sleeve and cannot be removed.*

- Remove the door trim panel from the carrier, using the pliers 3392 in the area of the attaching points.

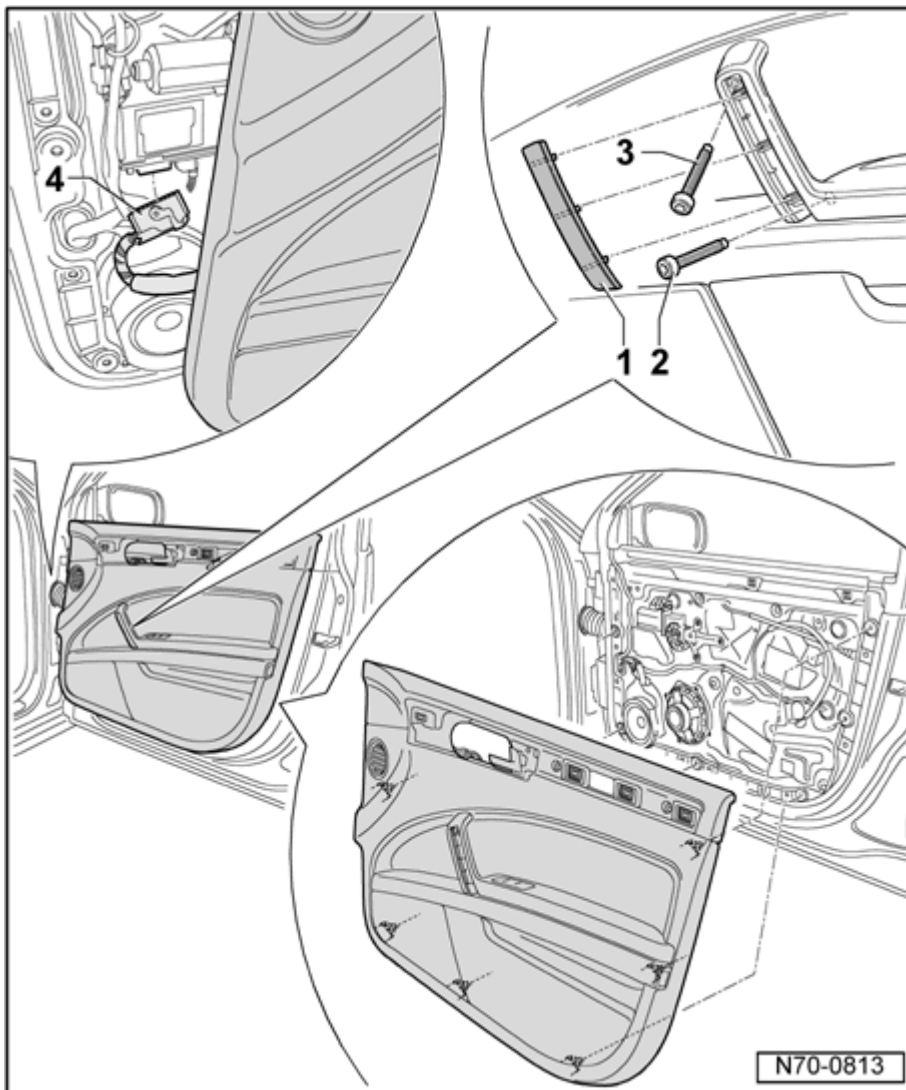

- Release the connector - **4** - and pull it out of the control module.
- Pull out the window frame trim - **1** - from the door seal weatherstrip and separate the speaker connector - **2** - .
- Remove the five bolts and remove the left support frame - **3** - (3.5 Nm).

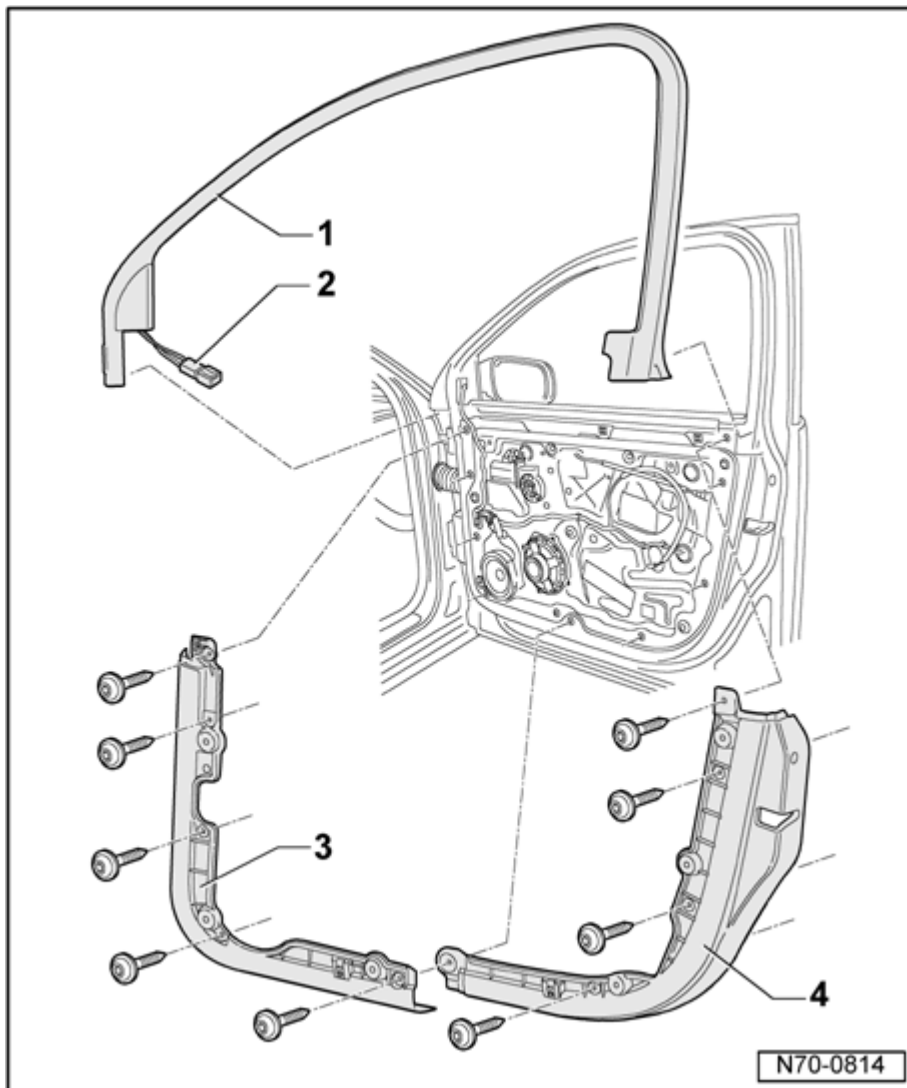

- Remove the four bolts and remove the right support frame - **4** - (3.5 Nm).

### Installing

- Installation is performed in the reverse order of removal.

### Installation notes:

- When the door trim, in the area of the retainers, is positioned in front of the corresponding openings in the door, push the door trim into the mountings.
- Then, fasten the bolts, which are secured against falling out via a sleeve.

### Rear door trim, removing and installing

#### **Note:**

- *Removal and installation is described for the right rear door trim panel. Removal and installation of the left rear door trim panel is performed in the same manner.*

### Removing

- Switch off ignition.
- Using the release lever T10039/1 pry out the panel upper edge molding - **1** - from the locking tabs, placing the release lever at the rear area of the panel.
- Carefully remove trim around door handle.
- Disconnect connector - **2** - .
- Remove bolts - **3** - , - **4** - and - **5** - behind the panel upper edge molding (3.5 Nm).

### **Note :**

- *On the extended version, there are two additional bolts installed behind the panel upper edge molding.*

- Remove bolt - **6** - (3.5 Nm).

### **Only for extended version vehicles**



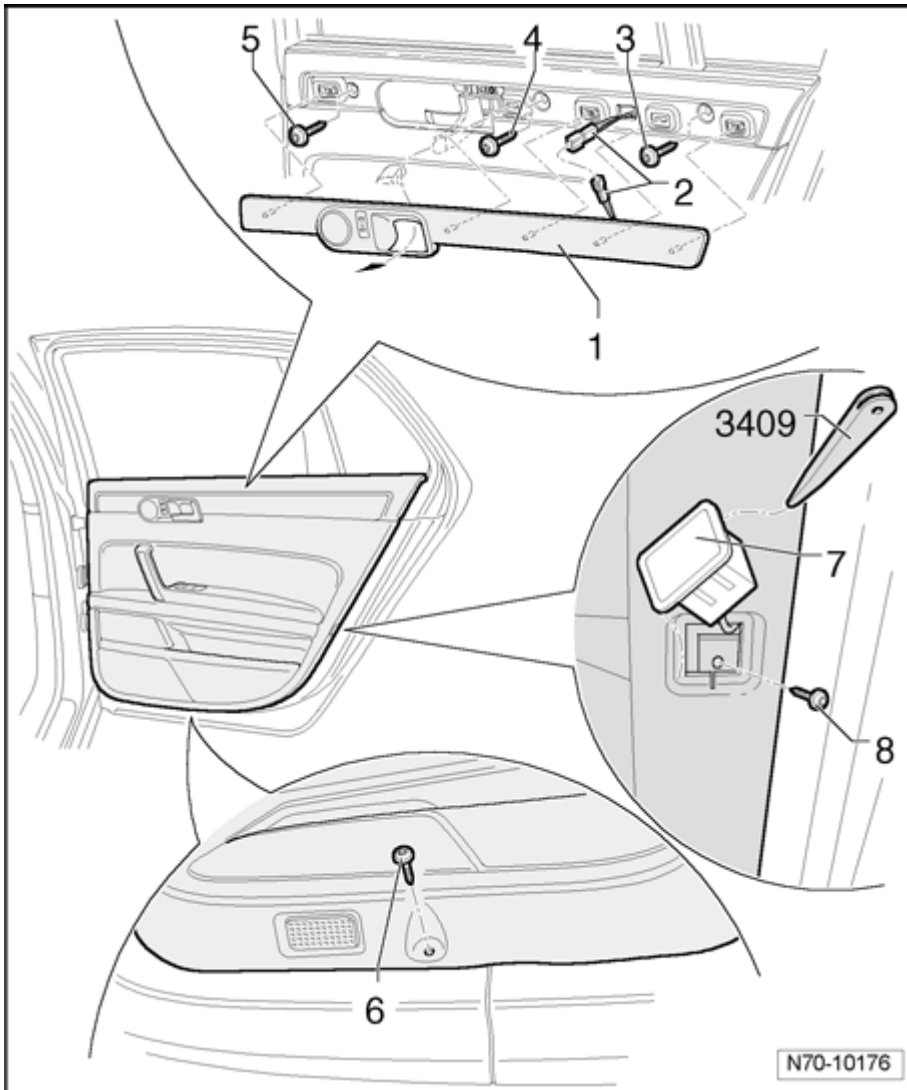

- Pry Right Rear Door Warning Light W38 - **7** - out of mount in door trim using wedge 3409 .

- Remove bolt - **8** - (3.5 Nm).

**All vehicles**

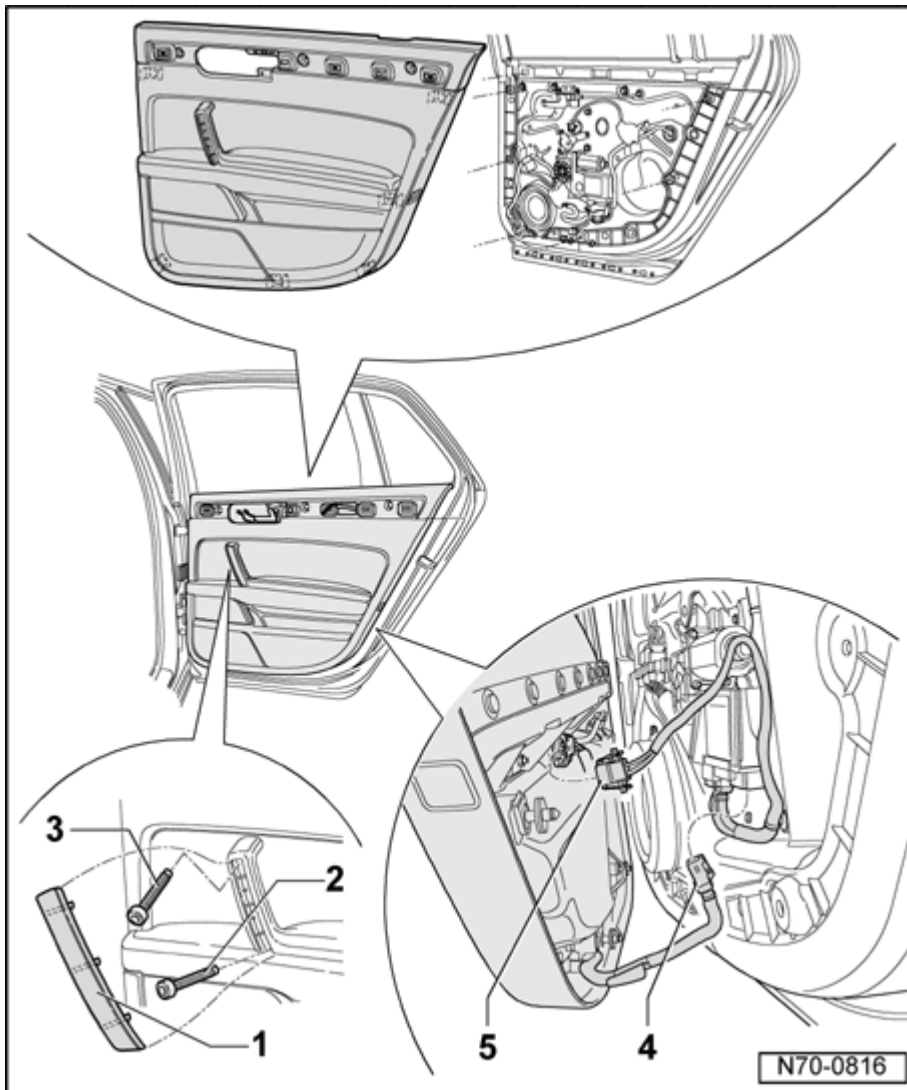

- Using a small screwdriver, remove the upper portion of the pull handle cover - **1** - from the locking tab.

- Remove bolts - **2** - and - **3** - (3.5 Nm).

**Note :**

- *The bolt - **2** - is secured with a sleeve and cannot be removed.*

- Remove the door trim panel from the carrier, using the pliers 3392 in the area of the attaching points.

- Release the connector - **4** - and pull it out of the control module.

- Disconnect connector - **5** - .

- Disconnect the Bowden cable for the

door lock actuator.

### Vehicles with sun shade

- Remove rear door trim panel ⇒ [70-2, Rear door trim, removing and installing](#)

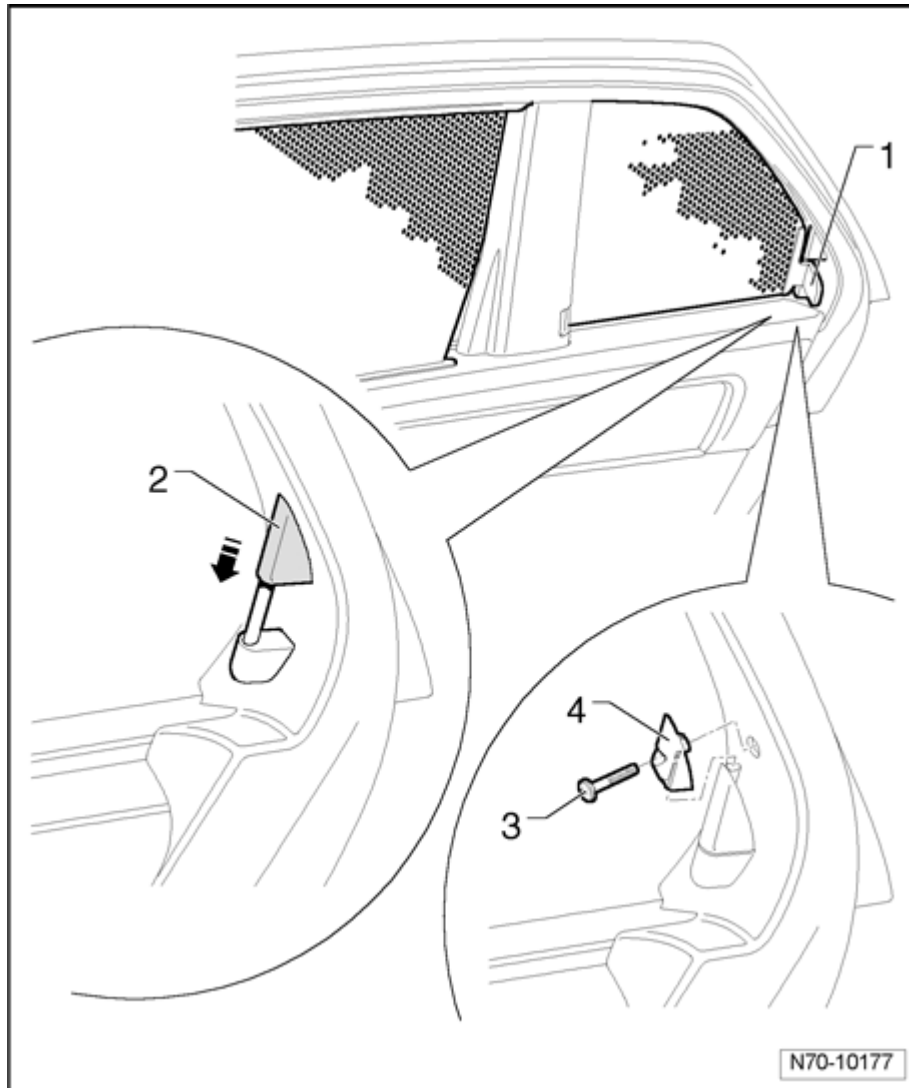

- Retract the sun shade - **1** - .
- Slide the cap - **2** - downward - **arrow** - and out of the lower mounting.
- Unscrew the bolt - **3** - (1.5 Nm) and remove the upper securing component - **4** - .

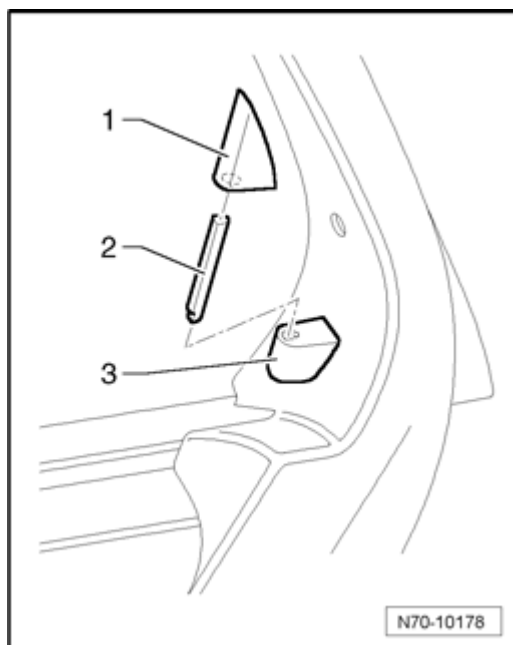

- Remove the cap - **1** - and the retainer - **2** - from the lower securing component - **3** - .

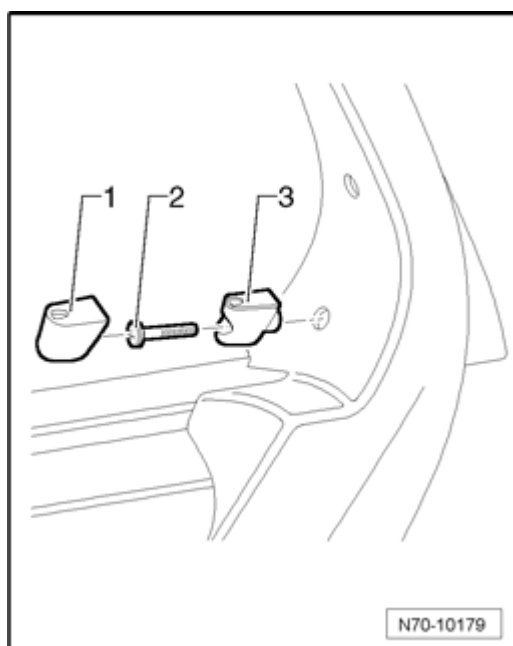

- Pull off the cap - **1** - .
- Unscrew the bolt - **2** - (1.5 Nm) and remove the lower securing component - **3** - .

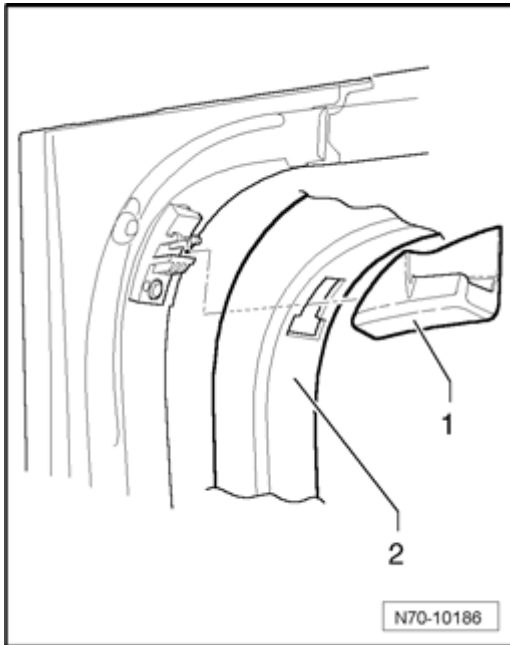

- At the front upper edge of the window frame, pull the sunshade mounting - **1** - out of the recess.

**Note:**

- *When installing, the sunshade mounting - **1** - must be replaced.*
- *To improve clarity, the sunshade mounting - **1** - and the support frame trim - **2** - are shown removed in the illustration.*

**Caution!**

***On earlier versions without cutout on inner lip of upper trim - **2** - as well as later versions with cutout on inner lip of upper trim - **2** - , care must be taken when removing upper trim piece so not to damage upper trim when removing from off of clip.***

**All vehicles**

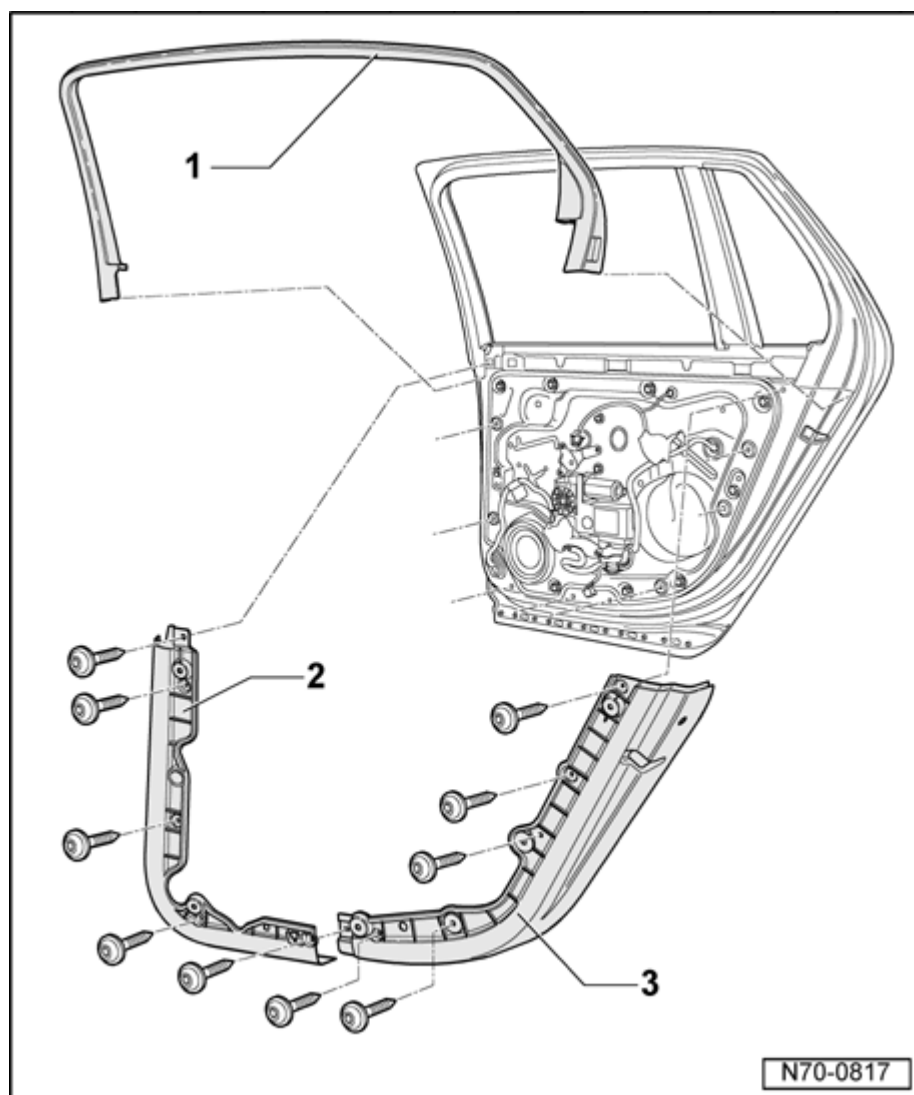

- Pull out the window frame trim - **1** - from the door seal weatherstrip.

- Remove the five bolts and remove the left support frame - **2** - (3.5 Nm).

- Remove the five bolts and remove the right support frame - **3** - (3.5 Nm).

**Note :**

- *On extended version vehicles, an additional filler piece is installed between the left and right support frames.*

**Vehicles with sun shade**

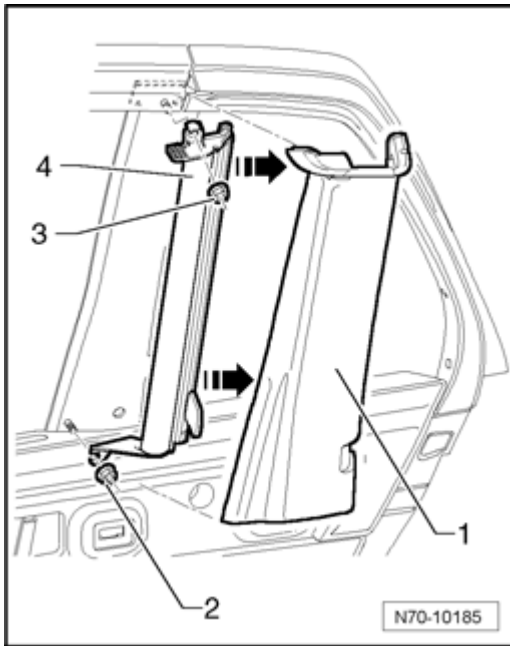

- Unclip front side of cover - **1** - and peel off from the rear sun shade channel toward the inside of vehicle and remove the underlying dampening.
- Remove nuts - **2** - and - **3** - (2 Nm).
- Push the sun shade - **4** - toward the rear and out of the mountings - **arrows** - .

### Installing

- Installation is performed in the reverse order of removal.

### Installation notes:

- When the door trim, in the area of the retainers, is positioned in front of the corresponding openings in the door, push the door trim into the mountings.
- Then, fasten the bolts, which are secured against falling out via a sleeve.